

HABITAT RESTORATION AREA RESTOCK

Author: u321351
 Scale @ A3: 1:5,000
 Date: 16/07/2021

Legend

-  LMP Area
-  Other Conifers with Other Broadleaves
-  Sitka Spruce with Lodgepole Pine
-  Other Broadleaves
-  Birch
-  Beech
-  Oak
-  Open
-  NMB Restock Area
-  Habitat Restoration Area
-  Forest Roads

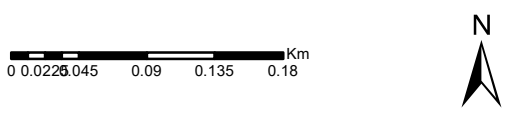

Reproduced by permission of Ordnance Survey on behalf of HMSO.
 © Crown copyright and database right [2021]. All rights reserved.
 Ordnance Survey Licence number [100021242].
 © Getmapping Plc and Bluesky International Limited 2021.

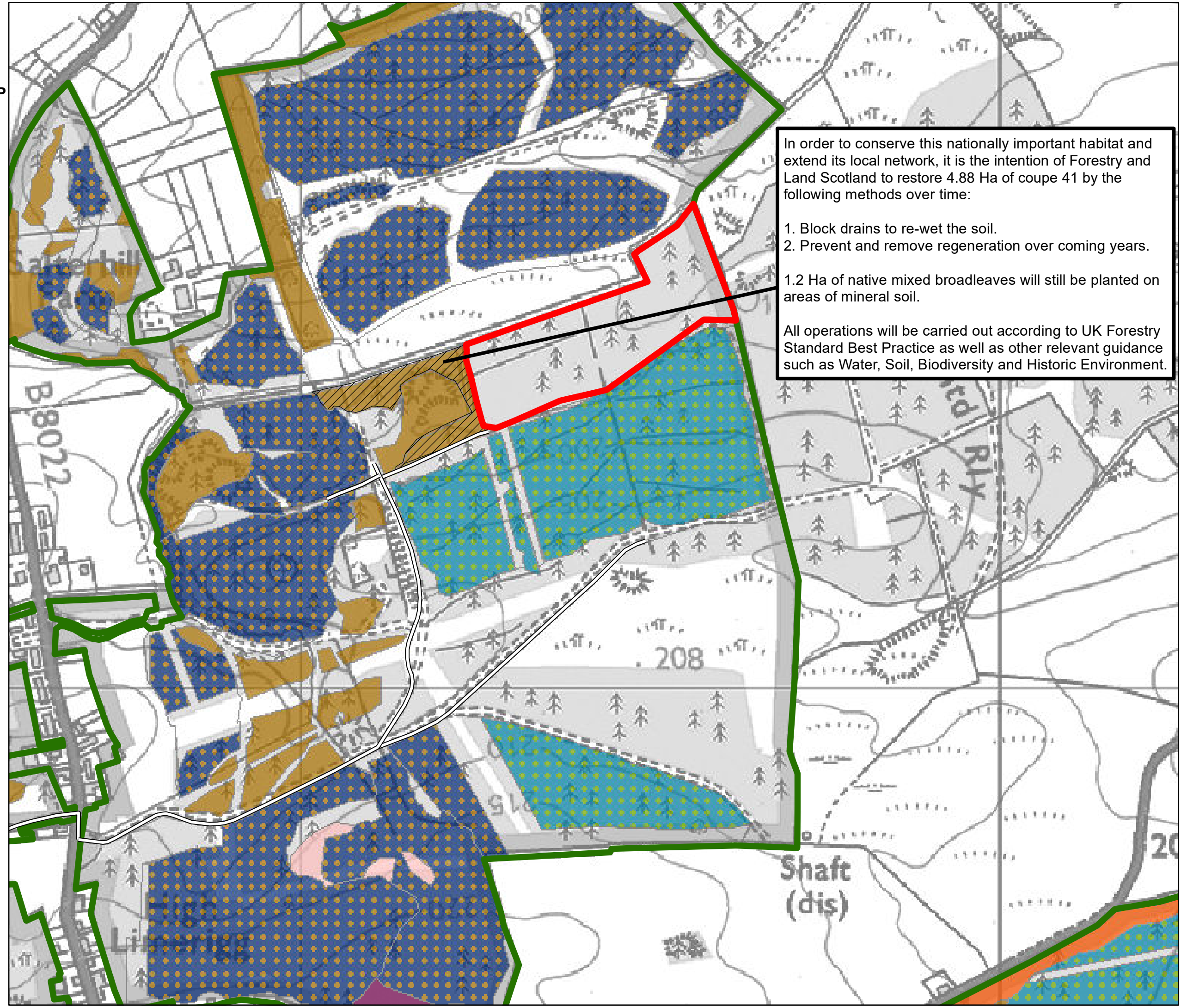

In order to conserve this nationally important habitat and extend its local network, it is the intention of Forestry and Land Scotland to restore 4.88 Ha of coupe 41 by the following methods over time:

1. Block drains to re-wet the soil.
2. Prevent and remove regeneration over coming years.

1.2 Ha of native mixed broadleaves will still be planted on areas of mineral soil.

All operations will be carried out according to UK Forestry Standard Best Practice as well as other relevant guidance such as Water, Soil, Biodiversity and Historic Environment.