

LAND MANAGEMENT PLAN

Map relevant to: Callander LMP 2025
Ref. No: 032/26/05
Map: Management Coupes & 10 Year Thinning

Owner/Lessee
Signature
Date: 25/06/2026
On behalf of Scottish Forestry
Signature: Alex Dean
Date: 24 June 2026

Callander Wood land management plan

Management coupes

Author: Central Region Planning Team

Scale @ A1: 1:3,500

Date: 16/02/2026

Legend

- Callander Wood LMP boundary
- Main forest operations entrance
- Existing forest tracks
- Planned forest track upgrade
- Phase 1 felling (2026 - 2030)
- Low Impact Silviculture
- Minimum Intervention
- Open

Estimated timber tonnage hauled from this forest entrance over next ten years = 16,980 tonnes

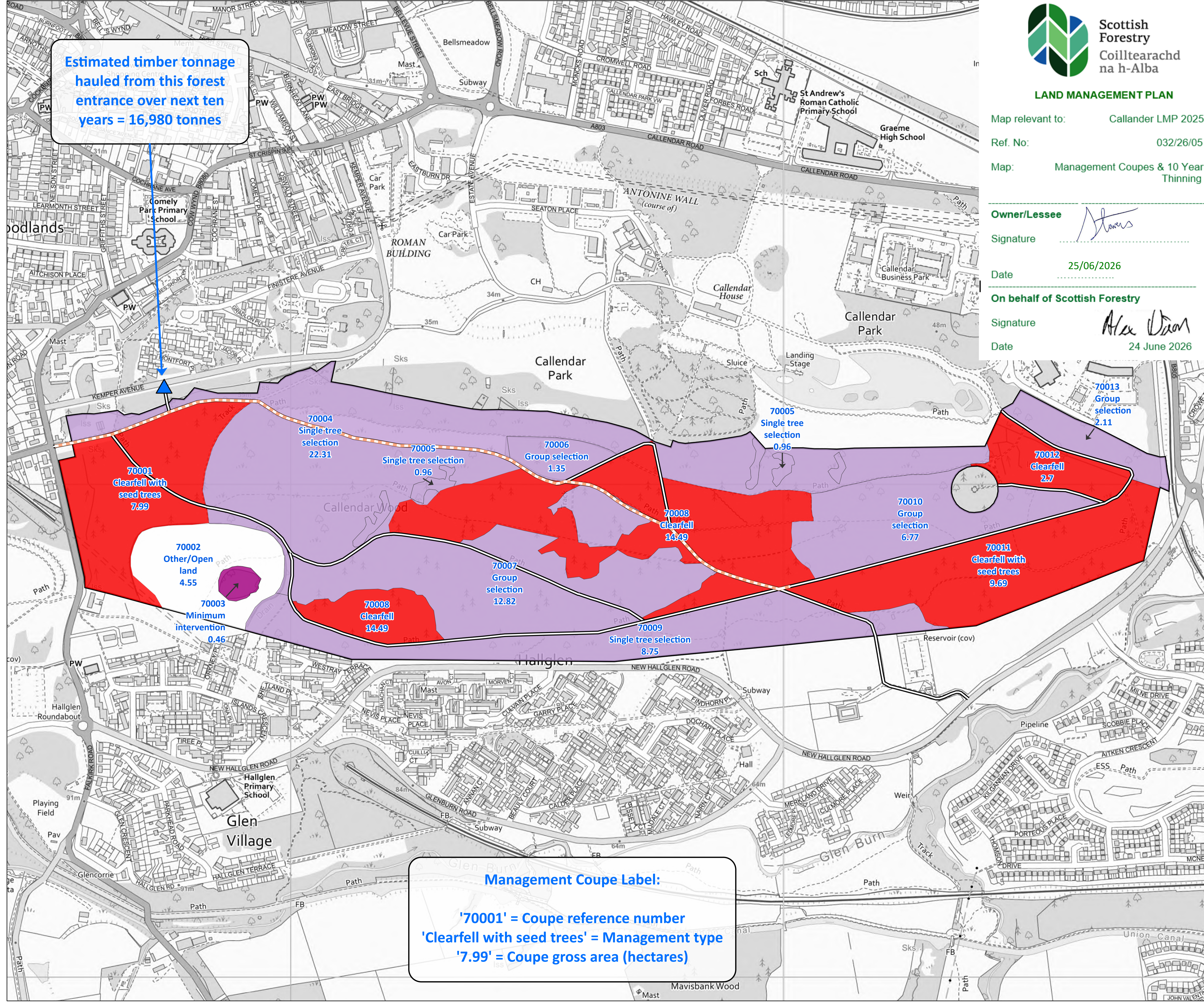

Management Coupe Label:
'70001' = Coupe reference number
'Clearfell with seed trees' = Management type
'7.99' = Coupe gross area (hectares)

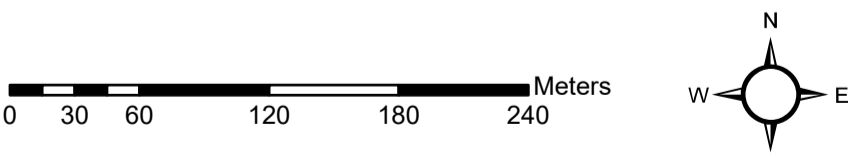

Reproduced by permission of Ordnance Survey on behalf of HMSO. © Crown copyright and database right (2026). All rights reserved. Ordnance Survey Licence number 100021242. © Getmapping Plc and Bluesky International Limited 2026.

**Callendar Wood
land management plan**





LMP thinning areas

Author: Central Region Planning Team

Scale @ A1: 1:3,500

Date: 28/01/2026

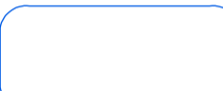
Legend

-  Callendar Wood LMP boundary
-  Main forest operations entrance
-  Forest Access
-  Sub-compartments
-  Proposed thinning areas 2026-36

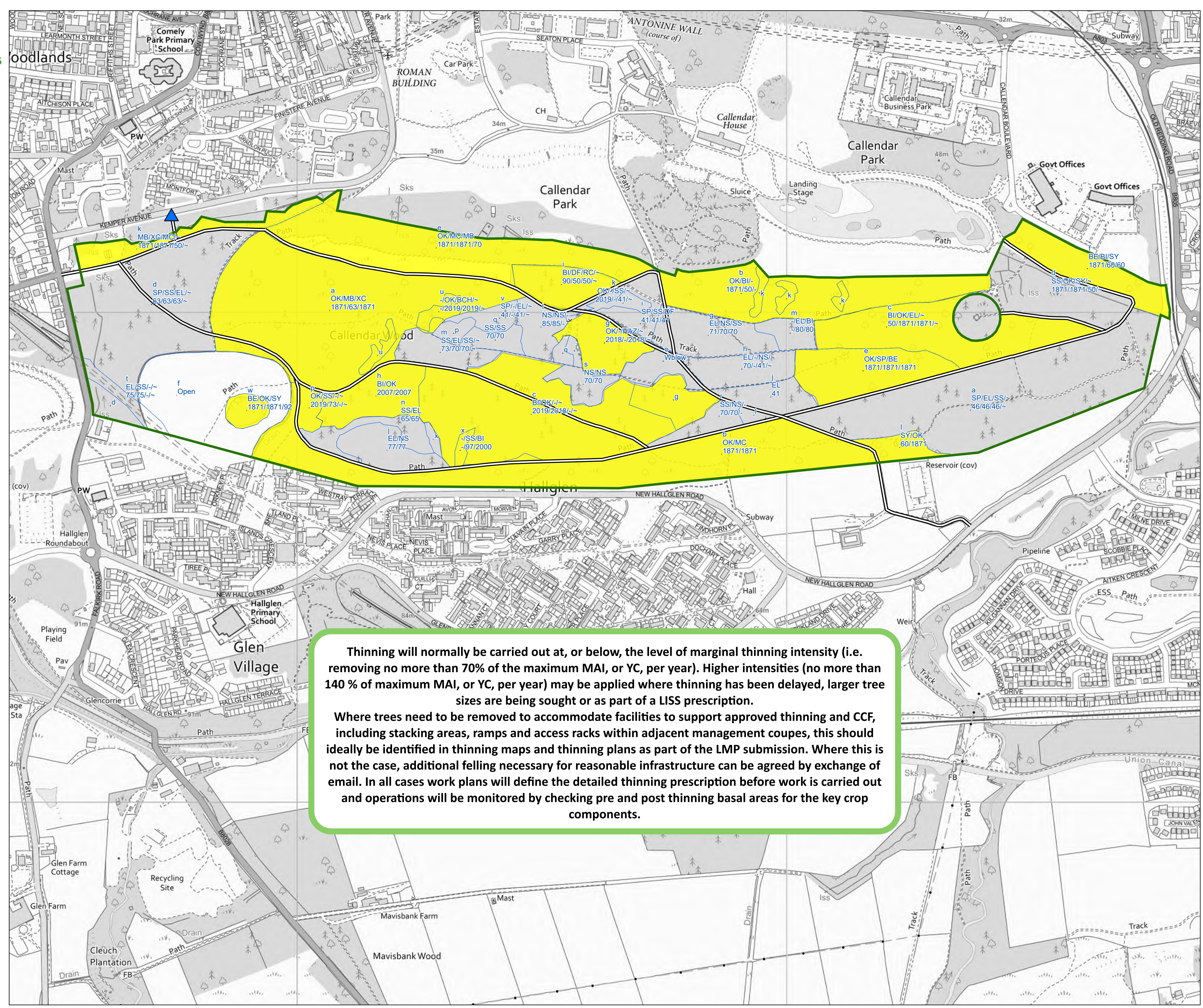

Thinning will normally be carried out at, or below, the level of marginal thinning intensity (i.e. removing no more than 70% of the maximum MAI, or YC, per year). Higher intensities (no more than 140 % of maximum MAI, or YC, per year) may be applied where thinning has been delayed, larger tree sizes are being sought or as part of a LISS prescription.

Where trees need to be removed to accommodate facilities to support approved thinning and CCF, including stacking areas, ramps and access racks within adjacent management coupes, this should ideally be identified in thinning maps and thinning plans as part of the LMP submission. Where this is not the case, additional felling necessary for reasonable infrastructure can be agreed by exchange of email. In all cases work plans will define the detailed thinning prescription before work is carried out and operations will be monitored by checking pre and post thinning basal areas for the key crop components.

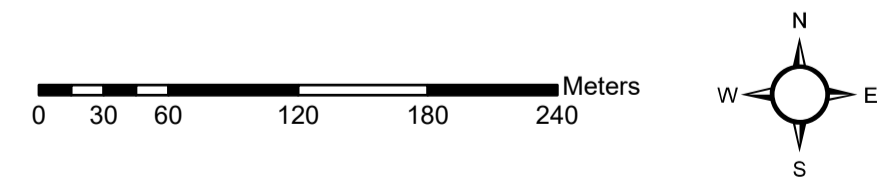

Reproduced by permission of Ordnance Survey on behalf of HMSO.
© Crown copyright and database right (2026). All rights reserved.
Ordnance Survey Licence number [100021242].
© Getmapping Plc and Bluesky International Limited 2026.