

### Map 7 - Timber Haulage2

Author: Eelco De Jong

Scale @ A3: 1:7,500

Date: 14/01/2025

#### Legend

##### Timber Transport Routes

- Agreed Route
- Consultation Route
- Restricted Route
- Severely Restricted Route
- Excluded Route
- In Forest Haul Road
- One Way Agreed Route
- - Permit Route

##### Forest Roads (Classification)

- Class A
- Class B
- Class C
- Restricted
- Transfer Point
- Unclassified

0 0.0350.07 0.14 0.21 0.28 km



Reproduced by permission of Ordnance Survey on behalf of HMSO.  
© Crown copyright and database right 2025. All rights reserved.  
Ordnance Survey Licence number 100024925.  
© Getmapping Plc and Bluesky International Limited 2025.

Scotland's national  
forests and land  
are responsibly  
managed to the  
UK Woodland  
Assurance Standard.

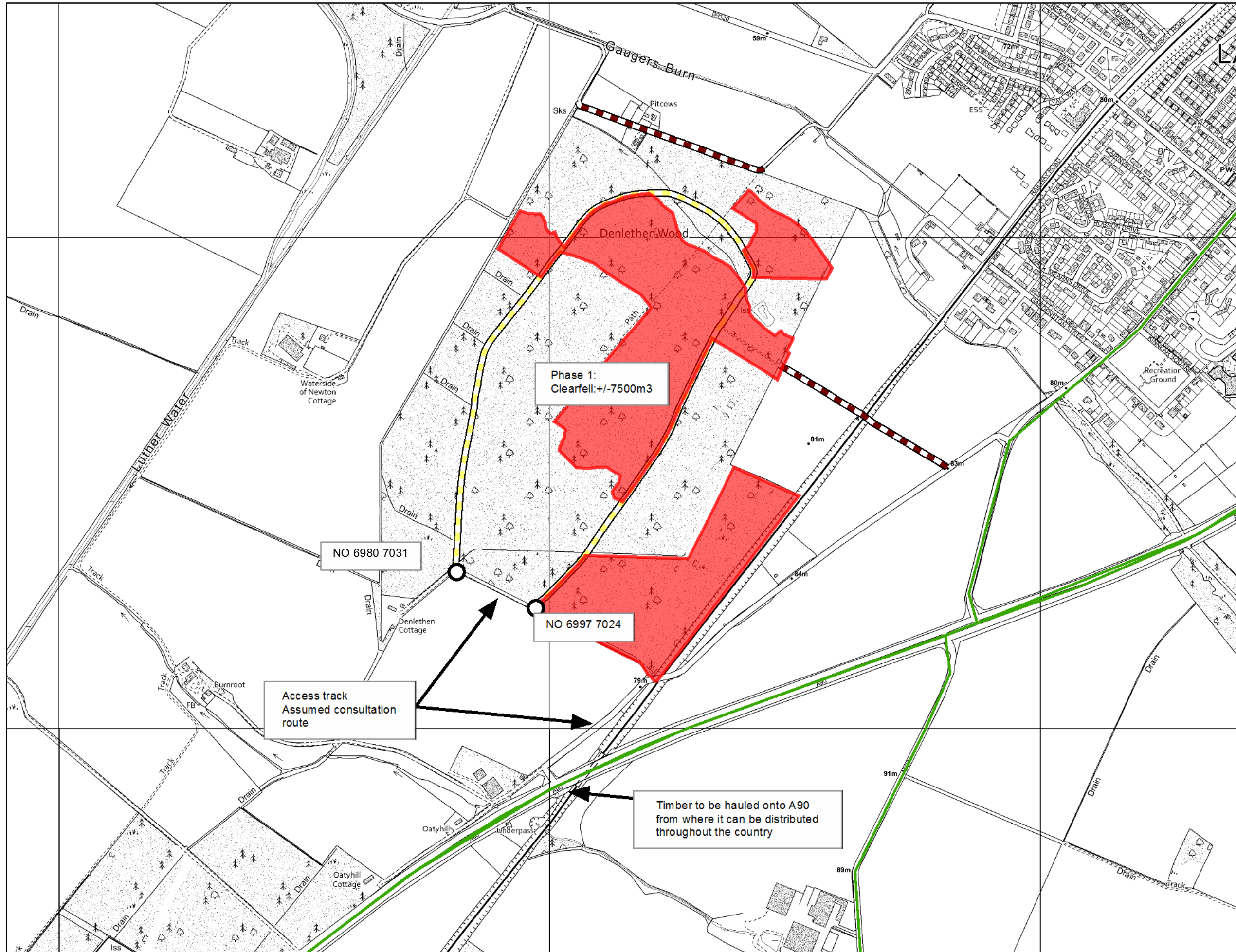

NO 6980 7031

NO 6997 7024

Access track  
Assumed consultation  
route

Timber to be hauled onto A90  
from where it can be distributed  
throughout the country

Phase 1:  
Clearfell: +/-7500m3