

Glenachulish Analysis Map

Author: Mandie Currie

Scale @ A3: 1:20,000

Date: 17/12/2020

Legend

- | | |
|------------------------------------|--|
| Watercourses | National Cycle Network National Routes (GB) |
| Watercourses | 0 |
| ASNW | 1 |
| PAWS | |
| Special Protection Areas | Land Management Plan Areas |
| Special Protection Areas | Land Management Plan Areas |
| Rec - Linear Assets | Coupes felled in last 5 yrs |
| Rec - Linear Assets | |
| Rec - Walking | Forest Roads |
| Easy | Rides |
| Easy - All Ability (Scotland Only) | Fences (Scot.) |
| Moderate | Heritage |
| Difficult | |
| Strenuous (Scotland Only) | |

ASNW = Ancient Semi-Natural Woodland

PAWS = Plantations on Ancient Woodland Sites

X = NN 0468 5899

0 0.075 0.15 0.3 0.45 0.6 km



Reproduced by permission of Ordnance Survey on behalf of HMSO.
© Crown copyright and database right 2020. All rights reserved.
Ordnance Survey Licence number 100024925.
© Getmapping Plc and Bluesky International Limited 2020.

Scotland's national forests and land are responsibly managed to the UK Woodland Assurance Standard.

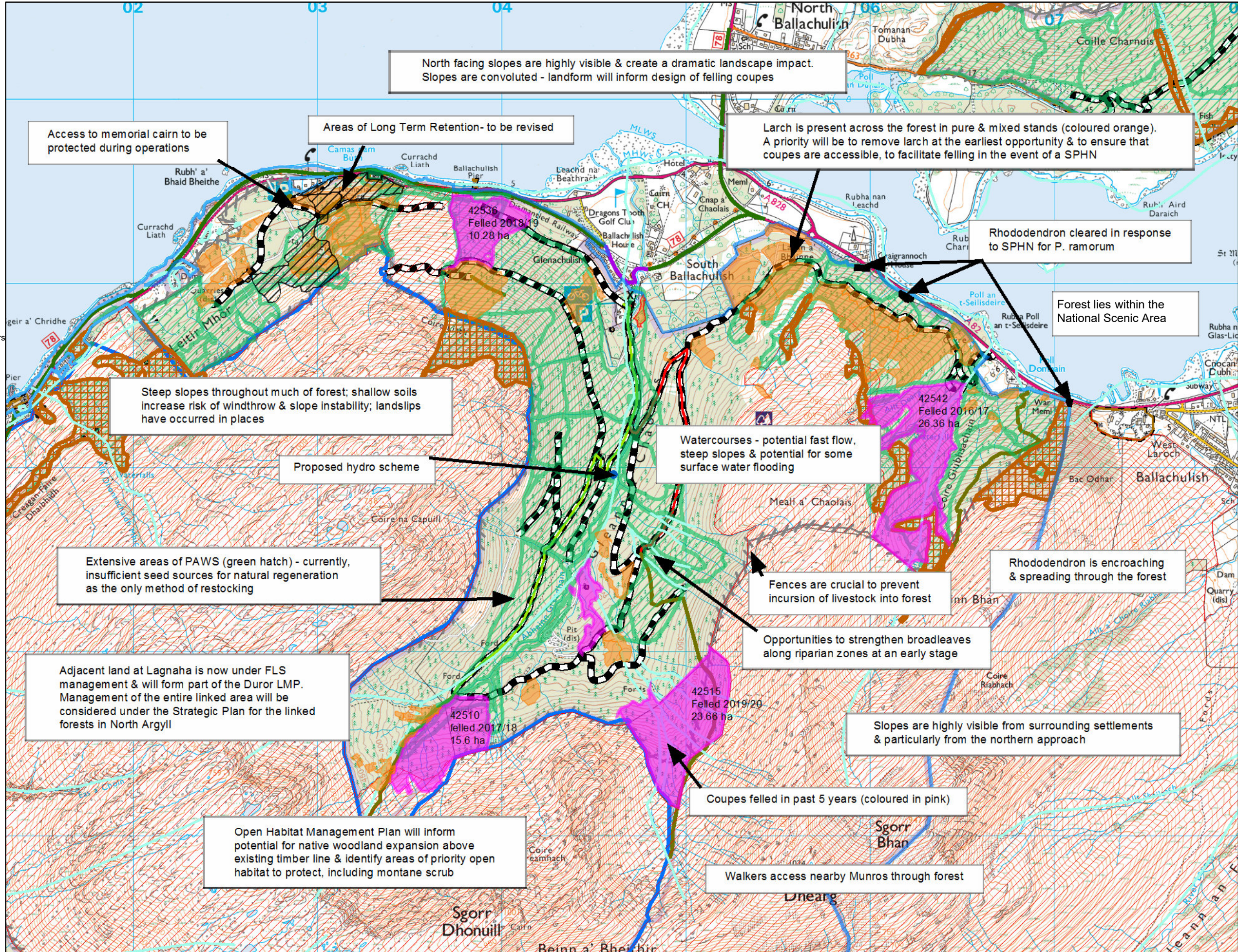

North facing slopes are highly visible & create a dramatic landscape impact. Slopes are convoluted - landform will inform design of felling coupes

Access to memorial cairn to be protected during operations

Areas of Long Term Retention- to be revised

Larch is present across the forest in pure & mixed stands (coloured orange). A priority will be to remove larch at the earliest opportunity & to ensure that coupes are accessible, to facilitate felling in the event of a SPHN

Rhododendron cleared in response to SPHN for P. ramorum

Forest lies within the National Scenic Area

Steep slopes throughout much of forest; shallow soils increase risk of windthrow & slope instability; landslips have occurred in places

Proposed hydro scheme

Watercourses - potential fast flow, steep slopes & potential for some surface water flooding

Fences are crucial to prevent incursion of livestock into forest

Rhododendron is encroaching & spreading through the forest

Extensive areas of PAWS (green hatch) - currently, insufficient seed sources for natural regeneration as the only method of restocking

Opportunities to strengthen broadleaves along riparian zones at an early stage

Adjacent land at Lagnaha is now under FLS management & will form part of the Duror LMP. Management of the entire linked area will be considered under the Strategic Plan for the linked forests in North Argyll

Slopes are highly visible from surrounding settlements & particularly from the northern approach

42510 felled 2017/18 15.6 ha

42515 Felled 2019/20 23.66 ha

Coupes felled in past 5 years (coloured in pink)

Open Habitat Management Plan will inform potential for native woodland expansion above existing timber line & identify areas of priority open habitat to protect, including montane scrub

Walkers access nearby Munros through forest