

CALENDAR WOOD CURRENT STOCK

Scale: 6,500 @ A3

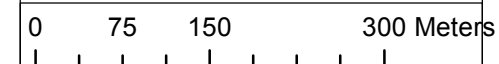

06 Aug 2015

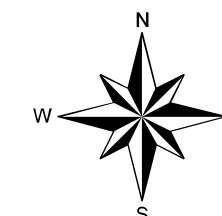

Legend

- Callendar_Wood
- Pines
- Spruces
- Larches
- Other Conifer
- Oak
- Beech
- Other Broadleaves

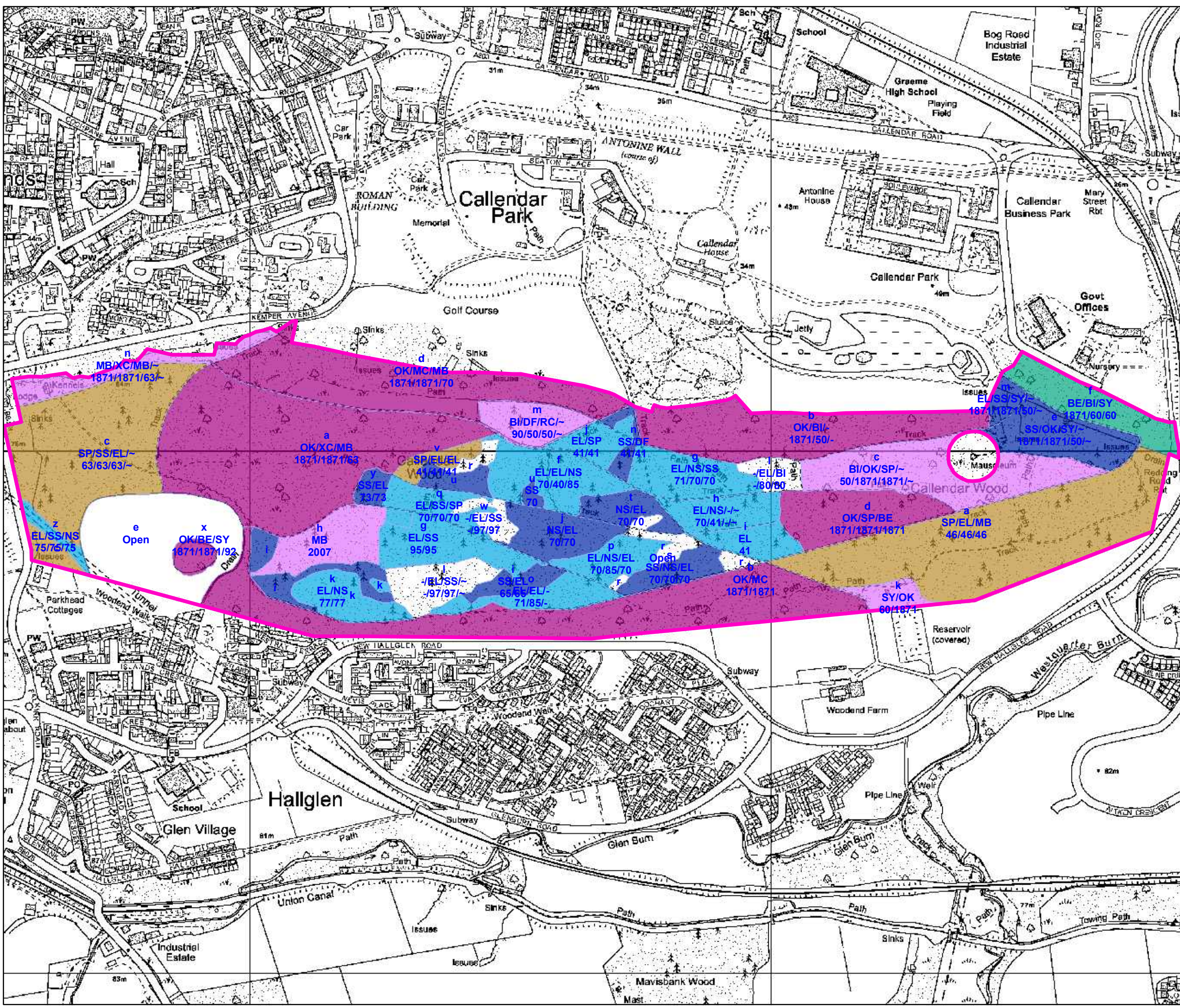

**CALLENDAR WOOD
NATIVE WOODLAND
SURVEY OF SCOTLAND**

Scale: 6,500 @ A3

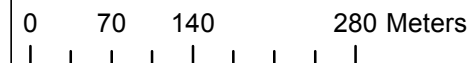

05 Aug 2015

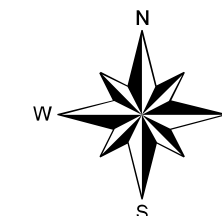

Legend

 Callendar_Wood

NWSS

TYPE

 Native woodland

 Nearly-native woodland

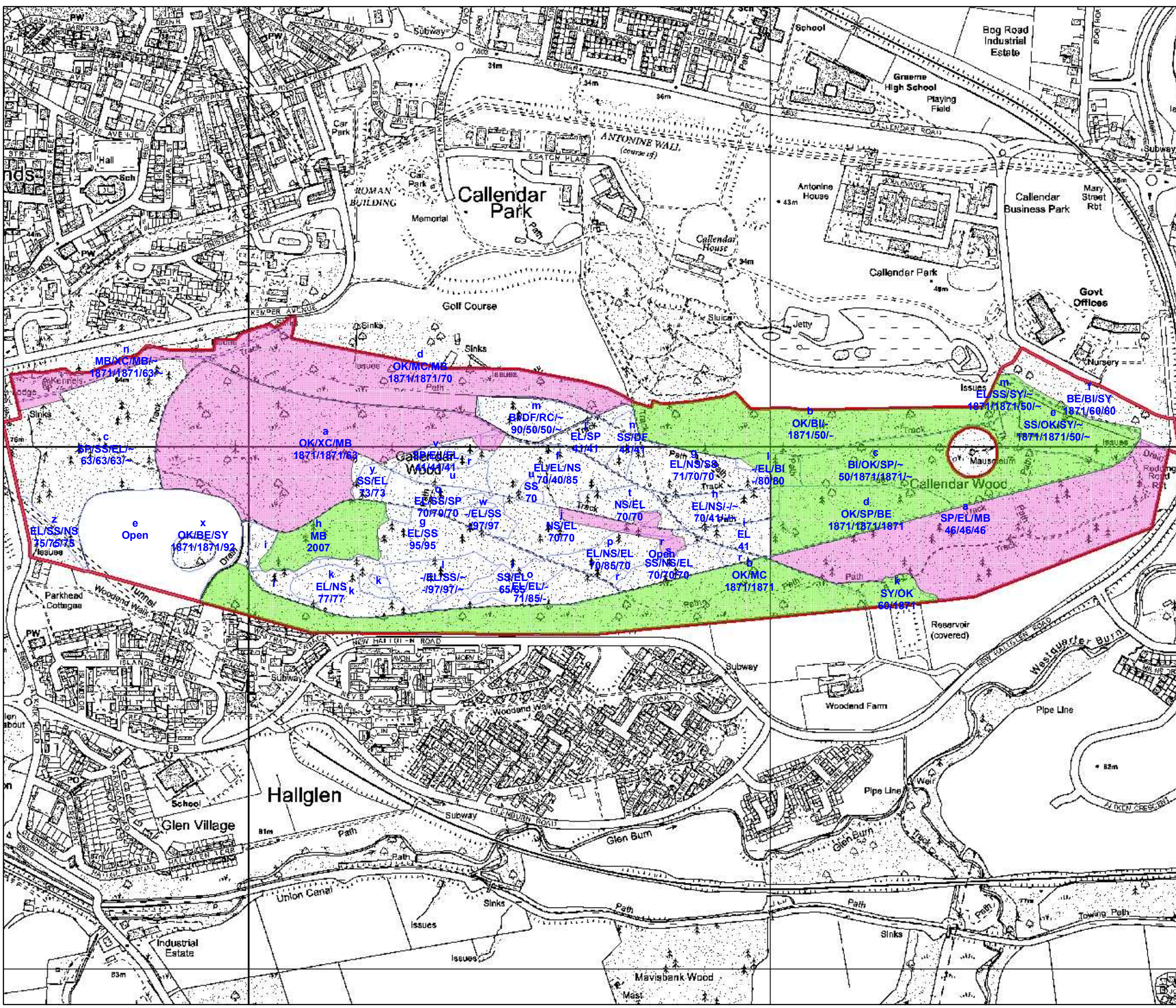

**CALENDAR WOOD
NATIONAL VEGETATION
CLASSIFICATION**



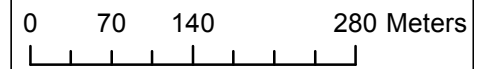

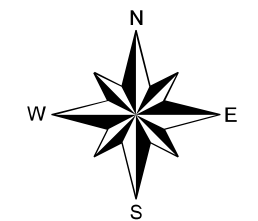

Scale: 6,500 @ A3



05 Aug 2015



Legend

-  Callendar_Wood
- Callendar_NVC**
- NVC_Classification**
-  MG1, False oat-grass
-  MG9a, Yorkshire fog / Tufted hair grass
-  W10e, Pedunculate oak / Blackberry / Bracken (Ash & Sycamore)
-  W11a, Sessile oak / Downy birch / Wood-sorrel (Broad buckler fern)
-  W25a, Blackberry-Bracken

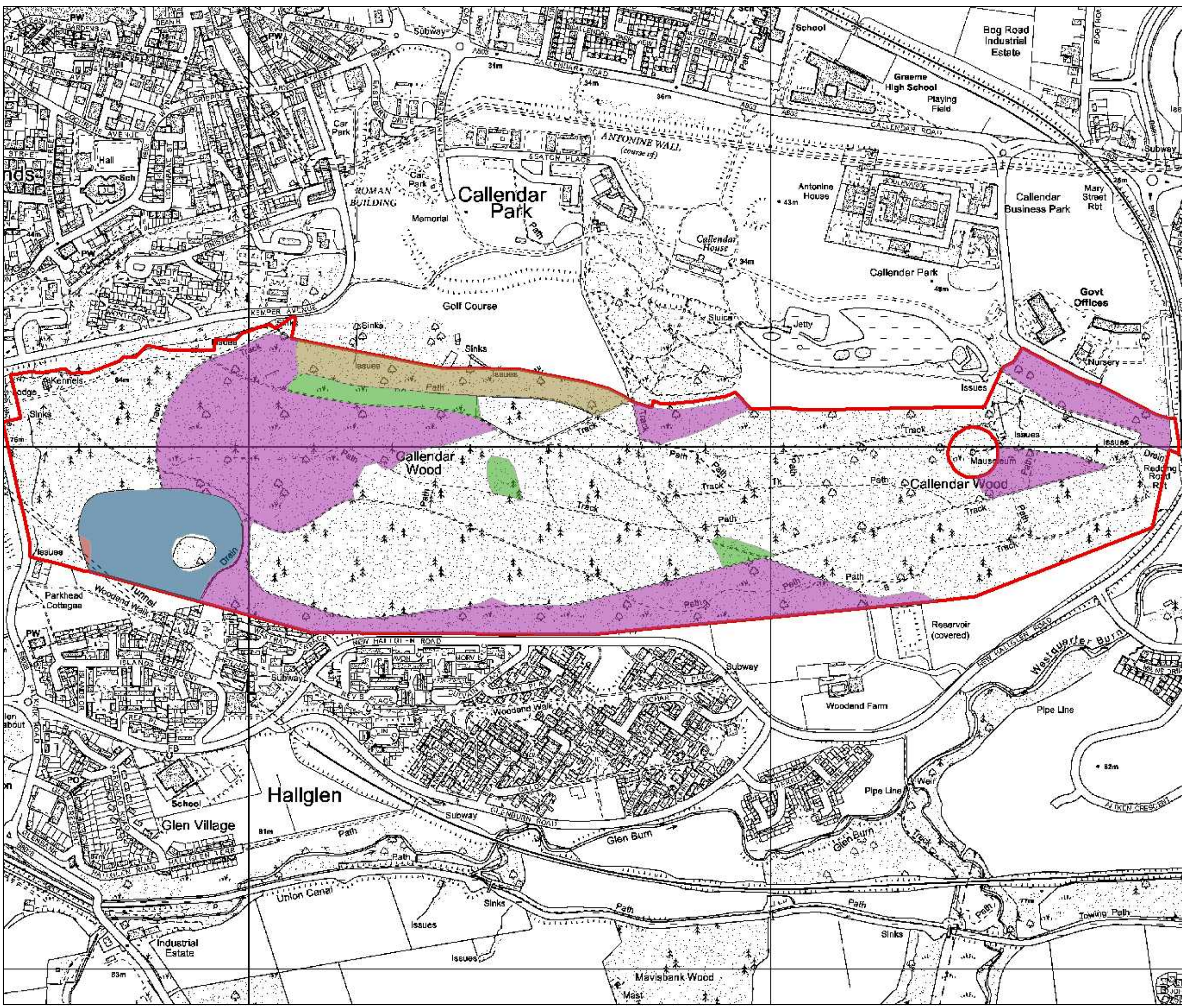

CALENDAR WOOD ANCIENT WOODLAND

Map 3d



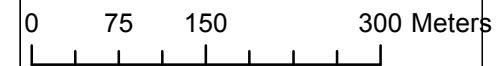

Scale: 6,500 @ A3

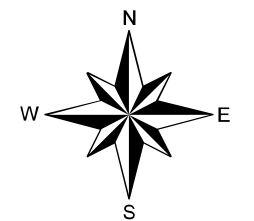

19 Jun 2015



Legend

-  Callendar_Wood
- Ancient Woodland Inventory**
 -  Ancient (of semi-natural origin)
 -  Long-Established (of plantation origin)
 -  Other (on Roy map)

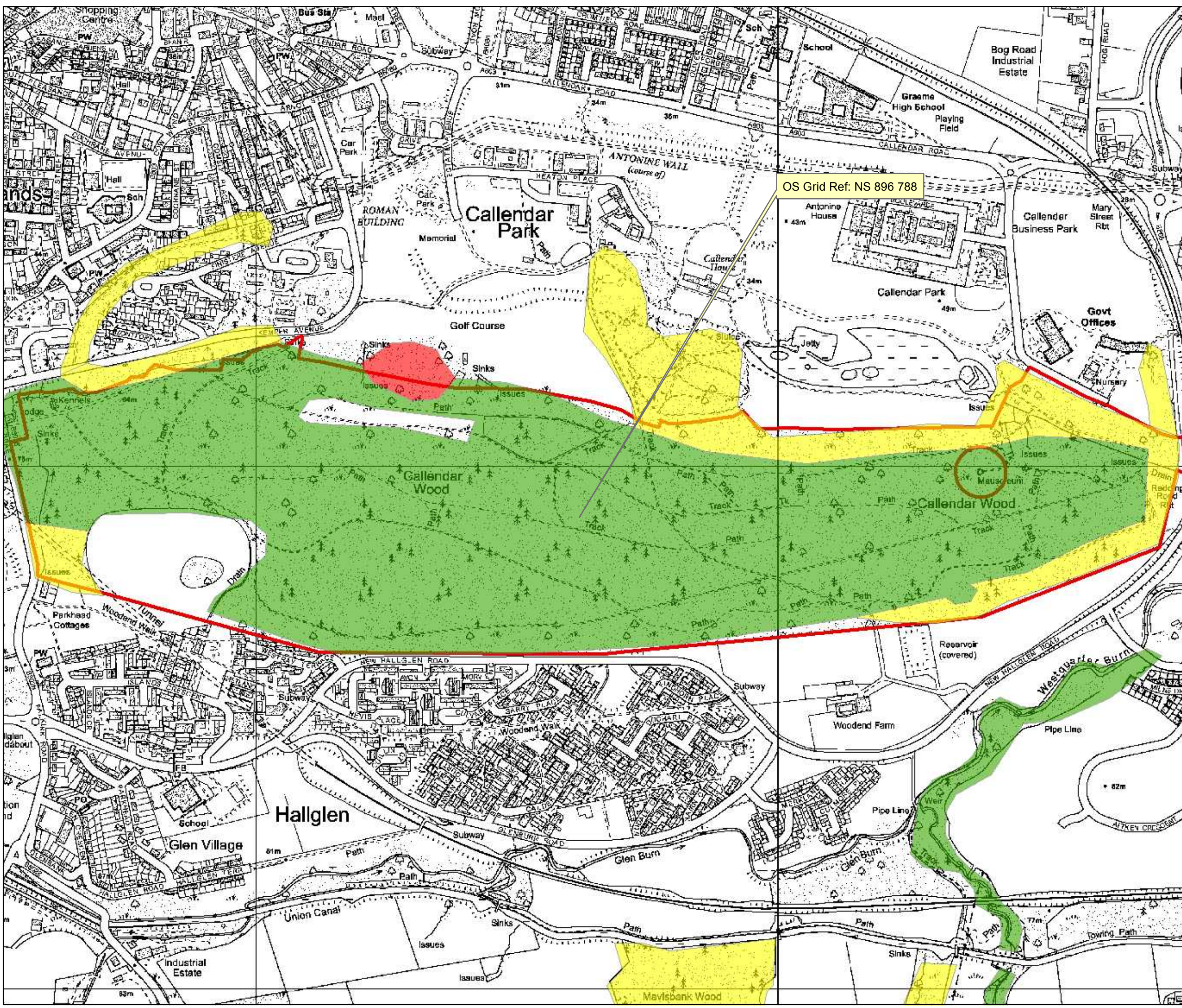

CALENDAR WOOD PAWS RESTORATION

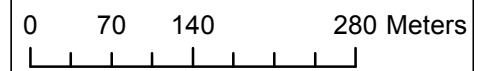

Scale: 6,500 @ A3

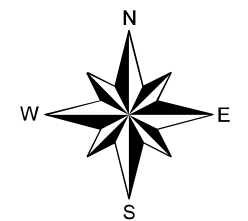

05 Aug 2015



Legend

-  Calendar_Wood
-  PAWS

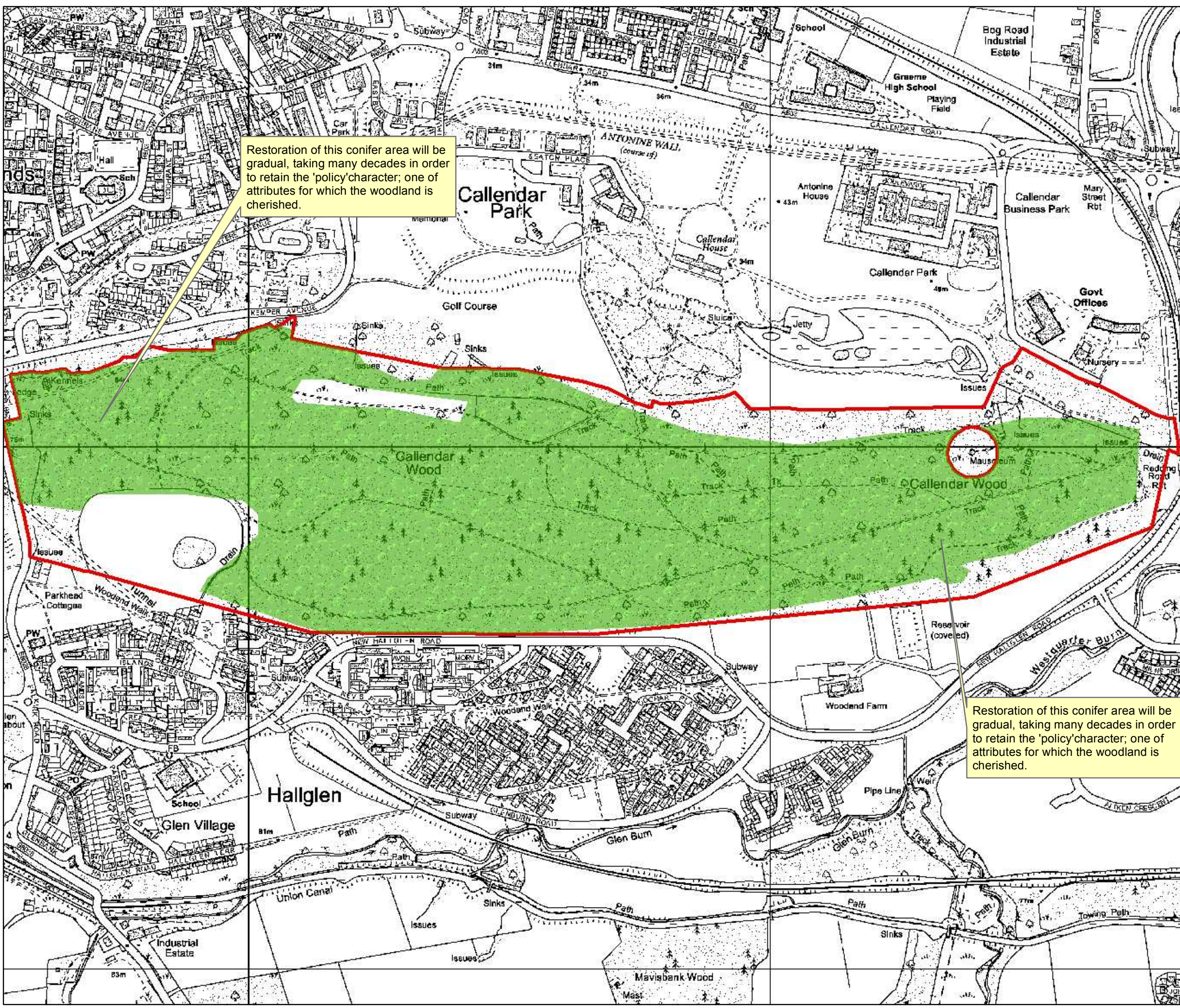

Restoration of this conifer area will be gradual, taking many decades in order to retain the 'policy' character; one of attributes for which the woodland is cherished.

Restoration of this conifer area will be gradual, taking many decades in order to retain the 'policy' character; one of attributes for which the woodland is cherished.

**CALENDAR WOOD
NWSS
DOMINANT HABITAT**

Scale: 6,500 @ A3

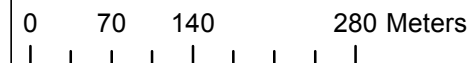

05 Aug 2015

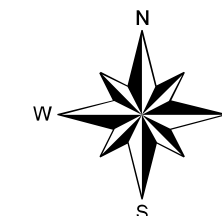

Legend

Calendar_Wood

NWSS

DOMINANT HABITAT

Upland birchwood

Upland mixed ashwood

Lowland mixed deciduous woodland

