

### Legend

**Classification**

- Class A
- Class B
- Class C
- Transfer Point
- Unclassified

**S\_TTG\_ROUTES**

**Transportation Route**

- Agreed Route
- Consultation Route
- Excluded Route
- Severely Restricted Route
- Unknown

**Management Area**

- Sub-Compartments
- Felled or fell year requires review (2011 - 2018)
- Phase 1 felling (2019 - 2023)
- Phase 2 felling (2024 - 2028)
- Phase 3 felling (2029 - 2033)
- Phase 4 felling (2034 - 2038)
- Phase 5 felling (2039 - 2043)
- Phase 6 felling (2044 - 2048)
- Phase 7 felling (2049 - 2053)
- Alter 2053
- Long term retention
- Natural reserve
- Minimum intervention
- Low impact silviculture
- Open

# North Region

## Inverness Woodlands Land Management Plan

### Map 4a Craig Phadraig Management Map

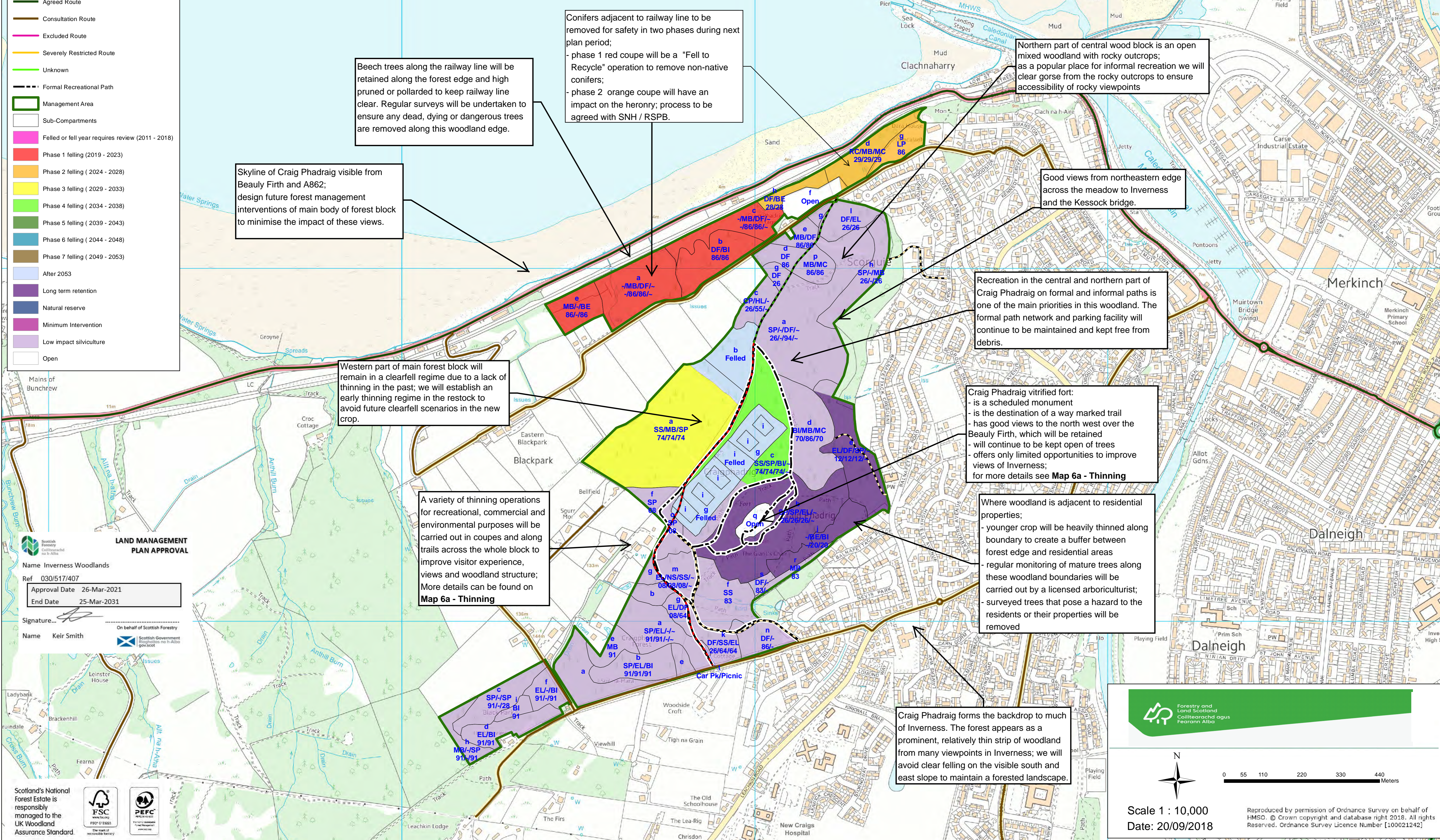

### Legend

- Broadleaved
- Broadleaved/Conifer
- Conifer
- Conifer/Broadleaved
- Douglas Fir
- Douglas Fir/Conifer
- Open
- Scots Pine
- Scots Pine/Broadleaved
- Scots Pine/Conifer
- Sitka Spruce
- Sitka Spruce/Conifer

# Inverness Ross & Skye Forest District

## Inverness Woodlands Land Management Plan

### Map 5a Craig Phadraig Species Map

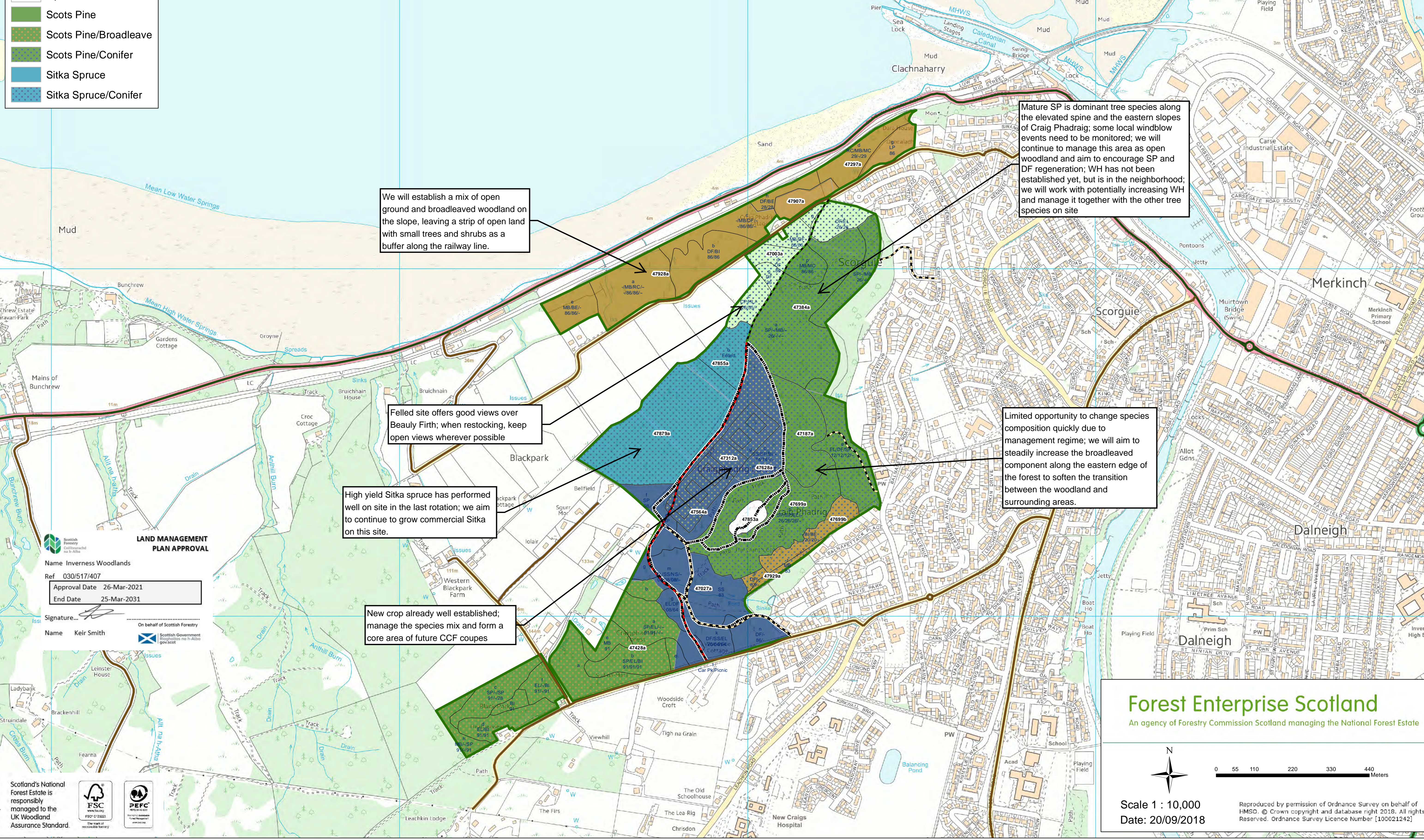

Forestry and Land Scotland  
Collaborating with the Forestry Commission

Scale 1 : 10,000  
Date: 20/09/2018

Reproduced by permission of Ordnance Survey on behalf of HMSO. © Crown copyright and database right 2018. All rights Reserved. Ordnance Survey Licence Number: [100021242]

Forest Enterprise Scotland  
An agency of Forestry Commission Scotland managing the National Forest Estate

Scale 1 : 10,000  
Date: 20/09/2018

Reproduced by permission of Ordnance Survey on behalf of HMSO. © Crown copyright and database right 2018. All rights Reserved. Ordnance Survey Licence Number: [100021242]